

# DOSRON<sup>®</sup>

## Tubular Motor User Manual

### Module Name

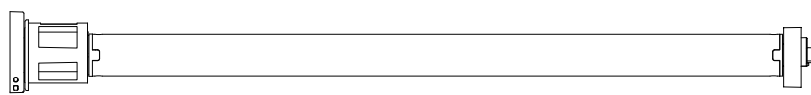

Tubular Motor



Remote

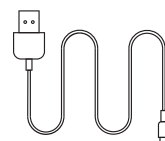

USB cable



Manual

### UI Description

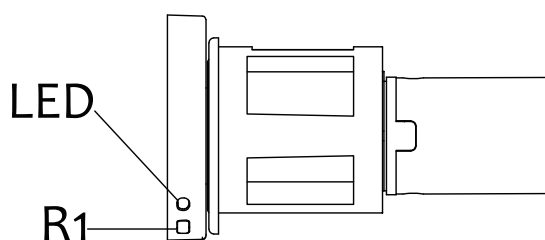

R1 button and LED indicator

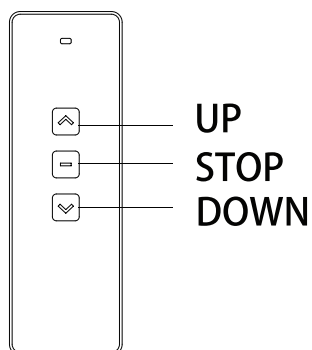

Front-side buttons

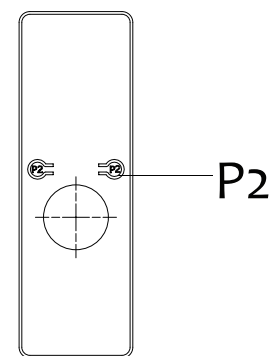

Back-side internal

### Device Operations

#### First-Time Use Guide:

Power on the motor → Pair the remote → Set top and bottom limit positions  
→ Set upper and lower learning positions

#### Power On

- 1.Short-press **R1** twice.  
(with an interval of less than 1 second between presses)
- 2.Blue light flash indicates successful power-on.

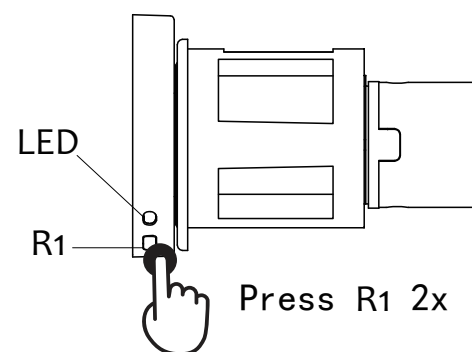

#### Power Off

- 1.Short-press **R1** 4 times.  
(with an interval of less than 1 second between presses)
- 2.Red light flash indicates successful power-off.

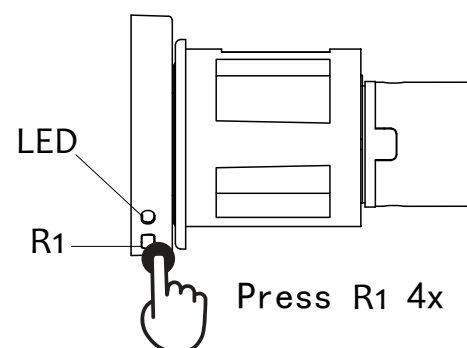

## Remote Pairing

- 1.Ensure the blind is at the top point.
- 2.Press and hold the "**Up**" button.
- 3.Press **R1** once, then release.
- 4.The red and blue LEDs flash alternately 3 times indicates successful pairing.

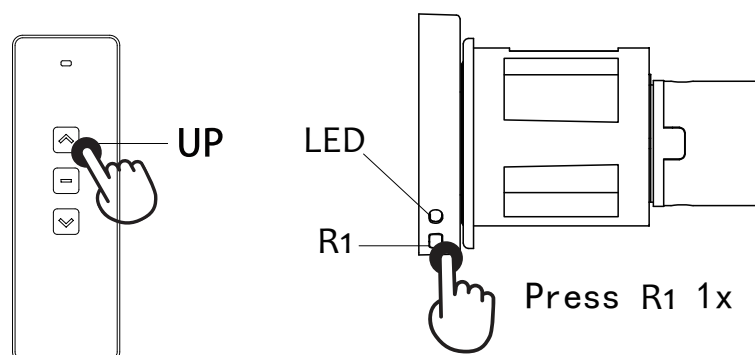

## Remote Deletion

- 1.Ensure the blind is at the top point.
- 2.Continuously short-press **R1** 6 times to clear all paired remotes.
- 3.The red and blue LEDs flash alternately 3 times indicates successful deletion.

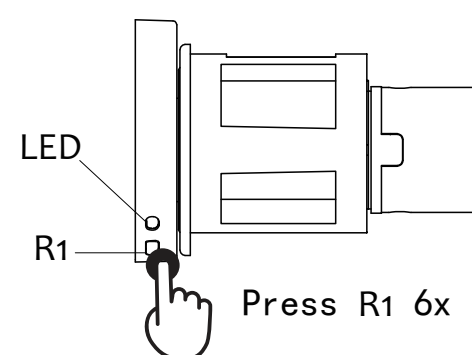

Note: After deleting old remotes and pairing new ones, you need to reset the limit and learning positions.

## Limit Positions Settings

### Top Limit Position Setting

1. Pull the blind to the top position.
2. Press the **R1** once, the red and blue LEDs flash alternately 3 times.
3. The setting is complete.

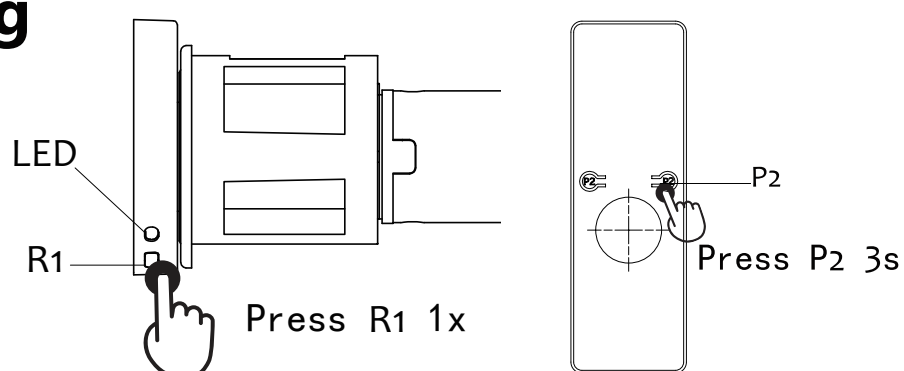

### Bottom Limit Position Setting

1. Pull the blind to the bottom position.
2. Open the back cover of the remote.
3. Press and hold **P2** for 3 seconds until the red and blue LEDs flash alternately 3 times.
4. Close the back cover, the setting is complete.

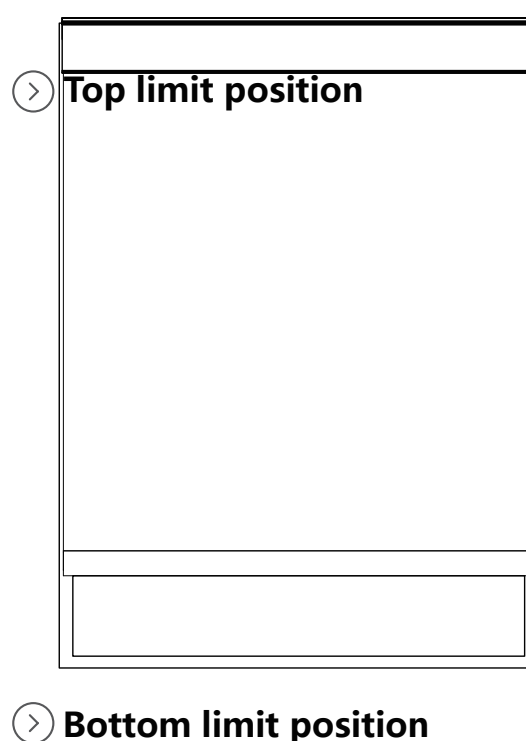

# Learning Position Settings

## Upper Learning Position Setting

- 1.Pull the blind to the desired highest position.
- 2.Long-press the "**STOP**" & "**UP**" simultaneously until the red and blue LEDs flash alternately 3 times (setting completed).

Function: After setting, pressing the "**UP**" once will directly run to this position. Long-pressing the button will run it to the top limit position.

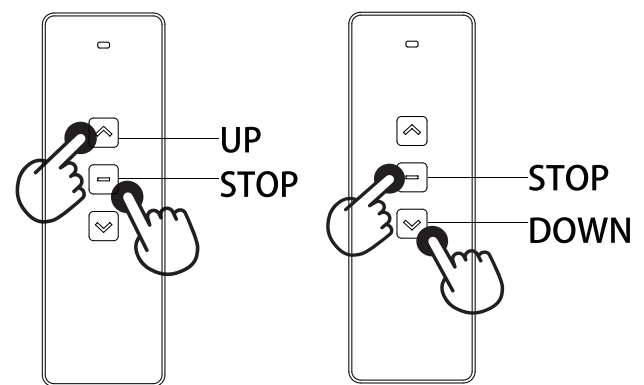

## Lower Learning Position Setting

- 1.Pull the blind to the desired lowest position.
- 2.Long-press the "**STOP**" & "**DOWN**" simultaneously until the red and blue LEDs flash alternately 3 times (setting completed).

Function: After setting, pressing the "**DOWN**" once will directly run to this position. Long-pressing the button will run it to the bottom limit position.

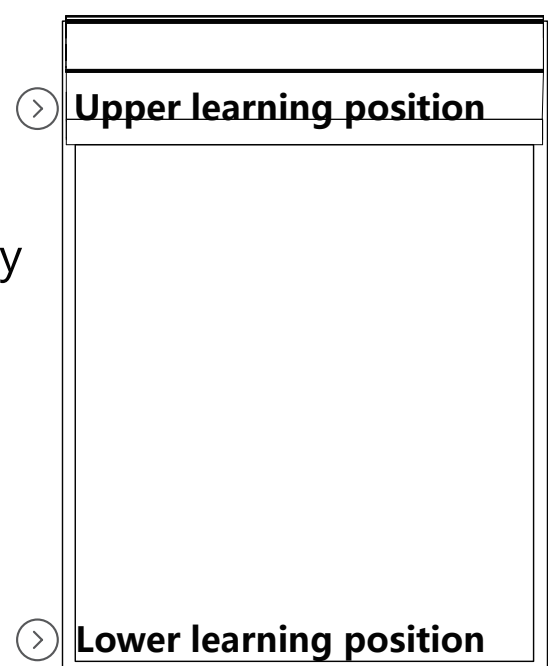

Note: If you want to change the learning position, simply repeat the steps.

## Charging instructions

- Before using the motor with batteries for the first time, please charge it for at least 10 hours to ensure that it is fully charged before use.
- It is recommended to fully charge the battery every 6 months to extend its lifespan.
- Under normal circumstances, the motor can be used for 6-9 months after being fully charged once.
- When the motor stops running, the indicator light will flash twice, and the red light indicates low battery. Please charge it in time.
- When controlled by the remote, if the motor does not start and the indicator light turns red twice, it indicates low battery protection and requires immediate charging.
- If the motor is not used for a long time, please press R1 4 times to turn it off.



Solar Charging



AC Adapter



Power Bank

## LED Light Status

Function	Status
Power On	Blue LED flashes once
Power Off	Red LED flashes once
Learning Positions Setting Success	Red and blue LEDs flash alternately 3 times
Bottom Limit Positions Setting Success	Red and blue LEDs flash alternately 3 times
Remote Pairing Success	Red and blue LEDs flash alternately 3 times
Clear all remotes	Red and blue LEDs flash alternately 3 times
Reaching Limit/Learning Position	Blue LED fast flashes 2 times/Red light flashes twice when the battery is low
Motor Stall	Blue LED fast flashes 2 times/Red light flashes twice when the battery is low
Remote Button Press	Blue LED flashes once/Red light flashes once when the battery is low
Push-Pull to Start	Blue LED flashes once/Red light flashes once when the battery is low
Low Battery	Red LED flashes twice
Charging	Blue LED flashes
Charging completed	Blue LED stays on steadily

## Technical Parameters

PRODUCT MODEL	Protection Class (mAh)	Charging Voltage(V)	Rated Power (W)	Rated Speed (RPM)	Rated Torque (Nm)	Continuous working hours(h)	Motor Length (mm)	Protection Class (IP)
DT25B0/28-32X		5	5	28	0.7	∞	326	20
DT25B1/28-32X	2600	5	5	28	0.7	∞	396	20
DT25B2/28-32X	5200	5	5	28	0.7	∞	461	20
DT25B0/28-38X		5	5	28	0.7	∞	326	20
DT25B1/28-38X	2600	5	5	28	0.7	∞	396	20
DT25B2/28-38X	5200	5	5	28	0.7	∞	461	20

## Cautions

### ⚠ High-Risk Warnings

- Do not throw the product into fire, as this may cause explosion, fire, or environmental pollution!
- Do not use in wet environments or expose to direct water. The controller contains high-voltage components.

### ⚠ Important Notices

- Keep the product out of reach of children to avoid damage from dropping or misuse.
- Operating Temperature: 0°C ~ 40°C.

### ⚠ Usage Tips

- Do not press remote button for too long to extend battery life. Press for approximately 0.5 seconds each time, with an interval of 1 second between presses.

Product appearance, color, and functions are subject to change. For any discrepancies, the physical product shall prevail.